



NDL Industries

## APPLICATIONS

Commercial, Industrial, and Residential CO<sub>2</sub> Refrigeration

# Stainless Steel Check Valves (CO<sub>2</sub>-CVS)

NDL CO<sub>2</sub> check valves perform unlike any other in its class for leak prevention, reliability, and superior field performance.



## CO<sub>2</sub>-CVS Specifications

### Exceptional Safety Margins

Our valves can hold *five* times their maximum working pressure, netting a tremendous safety margin for any ball valve used in CO<sub>2</sub> systems.

### Quality Tested

Each valve is helium tested at the factory to guarantee leak-free performance.

### Bottom-Up Stem Installation

Our stem placement is engineered from the bottom up. If there is an accidental over-pressurization in the valve, it will not blow the stem out and lose the charge.

### Stainless Steel Body

The NDL CO<sub>2</sub> valves feature a stainless steel body for stainless steel connections.

### Size and Connections

A wide range of sizes and connection types makes our valves compatible with main pipe types manufactured from copper iron alloys and stainless steel.

### Unparalleled Two-year Warranty

Our warranty proves confidence, along with stamping every valve with a serial number and cleanly packaging in a poly-bag to prevent contamination and malfunctions.



# Stainless Steel Check Valves

## Operating Specifications

- Temperature: -40° to 302°F (-40°C to 150°C)
- Burst Pressure: 5 times the working pressure

## Certifications and Approvals

- CE
- RoHS
- UL-Listed

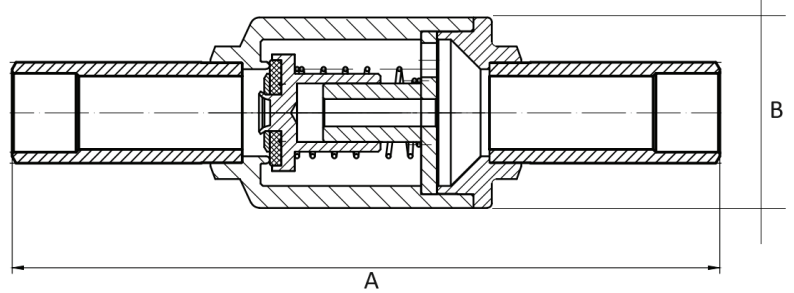

## Sizes, Kv/Cv, and Pressure Ratings

| PART NUMBER | CONNECTIONS<br>W | KV   | CV   | MAXIMUM OPERATING<br>PRESSURE |      |
|-------------|------------------|------|------|-------------------------------|------|
|             | MM               | M3/H | GPM  | BAR                           | PSI  |
| CO2-CVS10M  | 10               | 2    | 2.3  | 140                           | 2030 |
| CO2-CVS12M  | 12               | 2    | 2.3  | 140                           | 2030 |
| CO2-CVS16M  | 16               | 3.6  | 4.2  | 140                           | 2030 |
| CO20CVS18M  | 18               | 3.6  | 4.2  | 140                           | 2030 |
| CO2-CVS22M  | 22               | 8.5  | 9.8  | 140                           | 2030 |
| CO2-CVS28M  | 28               | 19   | 22.0 | 140                           | 2030 |
| CO2-CVS35M  | 35               | 29   | 33.5 | 140                           | 2030 |
| CO2-CVS42M  | 42               | -    | 0.0  | 140                           | 2030 |

Spring minimum opening pressure differential – 4.3 psi / 0.3 bar