



WROT Copper Fittings

TECHNICAL SPECIFICATIONS SUBMITTAL FORM

Job Name:	Submittal Date:	Wholesaler:
Job Location:	Engineer/Architect:	Contractor:

Product Use:

WROT Copper Sweat Fittings for use in Plumbing Applications.

Design and Features:

- Each fitting is marked with OD size for easy field identification.
- Fittings are poly-bagged within the box, keeping them clean and contaminant-free prior to installation.
- The fittings have tight tolerances on the cup side for a stronger joint with the tube and easier brazing.
- Our copper fittings have zero reported failures since 1999.

Certifications and Approvals:

- NSF 61
- ANSI/ASME B16.29, B16.15, B16.26, B16.24, B16.23





Female Adapters

Female Adapter Dimensions and Selection

	PART #	OD - DESCRIPTION	BOX QTY	L1 (IN)	WT (LB)	WT (G)
	CS3-04	1/4" Adapter	EA	0.906	0.033	15.0
	CS3-08	1/2" Adapter	25	1.122	0.064	29.0
	CS3-12	3/4" Adapter	25	1.437	0.095	43.0
	CS3-16	1" Adapter	20	1.732	0.165	75.0
	CS3-20	1-1/4" Adapter	10	1.909	0.276	125.0
	CS3-24	1-1/2" Adapter	10	2.126	0.392	178.0
	CS3-32	2" Adapter	2	2.421	0.613	278.0

The information contained herein is not intended to replace the full product installation and safety information available or the experience of a trained product installer. You are required to thoroughly read all installation instructions and product safety information before beginning the installation of a product.

All installations must completely comply with all NDL Industries warnings and instructions, national state and local codes and all applicable ANSI standards.

NDL Industries product specifications in U.S. customary units and metric are approximate and are provided for reference only. For precise measurements, please contact Customer

Service. NDL Industries reserves the right to change or modify product design, construction, specifications, or materials without prior notice and without incurring any obligation to make such changes and modifications on NDL products previously or subsequently sold.

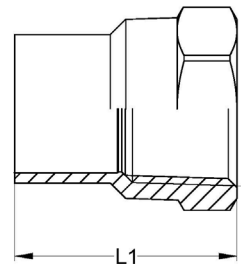

Explore our full line of high-quality HVAC-R and plumbing products.

ndlinc.com | 1-866-635-6888 | sales@ndlinc.com

@ndlindustries





Male Adapters

Male Adapter Dimensions and Selection

	PART #	OD - DESCRIPTION	BOX QTY	L1 (IN)	WT (LB)	WT (G)
	CS4-12	3/4" Adapter	25	1.368	0.093	42.0
	CS4-16	1" Adapter	20	1.673	0.152	69.0
	CS4-20	1-1/4" Adapter	10	1.693	0.254	115.0
	CS4-24	1-1/2" Adapter	10	1.909	0.342	155.0
	CS4-32	2" Adapter	2	2.264	0.518	235.0

The information contained herein is not intended to replace the full product installation and safety information available or the experience of a trained product installer. You are required to thoroughly read all installation instructions and product safety information before beginning the installation of a product.

All installations must completely comply with all NDL Industries warnings and instructions, national state and local codes and all applicable ANSI standards.

NDL Industries product specifications in U.S. customary units and metric are approximate and are provided for reference only. For precise measurements, please contact Customer

Service. NDL Industries reserves the right to change or modify product design, construction, specifications, or materials without prior notice and without incurring any obligation to make such changes and modifications on NDL products previously or subsequently sold.

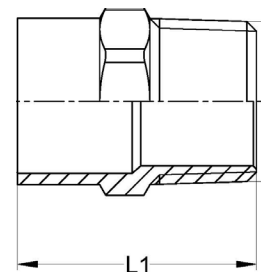

Explore our full line of high-quality HVAC-R and plumbing products.

ndlinc.com | 1-866-635-6888 | sales@ndlinc.com

@ndlindustries





Female Reducing Adapters

Female Reducing Adapter Dimensions and Selection

	PART #	OD - DESCRIPTION	BOX QTY	L1 (IN)	WT (LB)	WT (G)
	CS3-08-06	1/2" x 3/8" Reducing Adapter	25	0.945	0.079	36.0
	CS3-06-08	3/8" x 1/2" Reducing Adapter	25	1.181	0.090	41.0
	CS3-08-12	1/2" x 3/4" Reducing Adapter	25	1.299	0.110	50.0
	CS3-10-12	5/8" x 3/4" Reducing Adapter	EA	1.457	0.141	64.0
	CS3-24-20	1-1/2" x 1-1/4" Reducing Adapter	EA	1.831	0.381	173.0

The information contained herein is not intended to replace the full product installation and safety information available or the experience of a trained product installer. You are required to thoroughly read all installation instructions and product safety information before beginning the installation of a product.

All installations must completely comply with all NDL Industries warnings and instructions, national state and local codes and all applicable ANSI standards.

NDL Industries product specifications in U.S. customary units and metric are approximate and are provided for reference only. For precise measurements, please contact Customer

Service. NDL Industries reserves the right to change or modify product design, construction, specifications, or materials without prior notice and without incurring any obligation to make such changes and modifications on NDL products previously or subsequently sold.

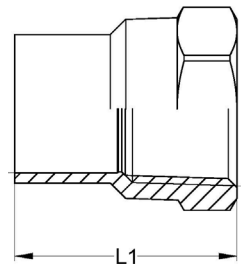

Explore our full line of high-quality HVAC-R and plumbing products.

ndlinc.com | 1-866-635-6888 | sales@ndlinc.com

@ndlindustries





Male Reducing Adapters

Male Reducing Adapter Dimensions and Selection

	PART #	OD - DESCRIPTION	BOX QTY	L1 (IN)	WT (LB)	WT (G)
	CS4-08-04	1/2" x 1/4" Reducing Adapter	EA	1.142	0.04	18
	CS4-08-06	1/2" x 3/8" Reducing Adapter	25	0.965	0.079	36
	CS4-08-12	1/2" x 3/4" Reducing Adapter	25	1.378	0.13	59
	CS4-10-12	5/8" x 3/4" Reducing Adapter	EA	1.584	0.141	64
	CS4-16-12	1" x 3/4" Reducing Adapter	25	1.791	0.19	86
	CS4-12-16	3/4" x 1" Reducing Adapter	-	2.106	0.221	100
	CS4-20-16	1-1/4" x 1" Reducing Adapter	EA	1.969	0.28	127
	CS4-16-20	1" x 1-1/4" Reducing Adapter	EA	2.146	0.381	173
	CS4-24-20	1-1/2" x 1-1/4" Reducing Adapter	EA	1.929	0.45	204
	CS4-24-16	1-1/2" x 1" Reducing Adapter	5	2.185	0.47	213

The information contained herein is not intended to replace the full product installation and safety information available or the experience of a trained product installer. You are required to thoroughly read all installation instructions and product safety information before beginning the installation of a product.

All installations must completely comply with all NDL Industries warnings and instructions, national state and local codes and all applicable ANSI standards.

NDL Industries product specifications in U.S. customary units and metric are approximate and are provided for reference only. For precise measurements, please contact Customer

Service. NDL Industries reserves the right to change or modify product design, construction, specifications, or materials without prior notice and without incurring any obligation to make such changes and modifications on NDL products previously or subsequently sold.

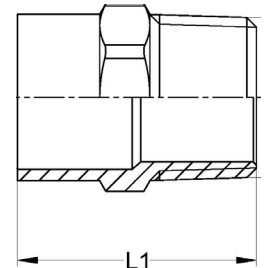

Explore our full line of high-quality HVAC-R and plumbing products.

ndlinc.com | 1-866-635-6888 | sales@ndlinc.com

@ndlindustries





Female Street Adapters

Female Street Adapter Dimensions and Selection

	PART #	OD - DESCRIPTION	BOX QTY	L1 (IN)	WT (LB)	WT (G)
	CS3-2-08	1/2" Street Adapter	25	1.417	0.071	32.0
	CS3-2-08-06	1/2" x 3/8" Street Adapter	EA	1.083	0.079	36.0
	CS3-2-12	3/4" Street Adapter	25	1.693	0.128	58.0
	CS3-2-16	1" Street Adapter	10	1.988	0.229	104.0
	CS3-2-20	1-1/4" Street Adapter	EA	2.126	0.331	150.0
	CS3-2-24	1-1/2" Street Adapter	EA	2.362	0.461	209.0
	CS3-2-32	2" Street Adapter	25	3.839	0.710	322.0

The information contained herein is not intended to replace the full product installation and safety information available or the experience of a trained product installer. You are required to thoroughly read all installation instructions and product safety information before beginning the installation of a product.

All installations must completely comply with all NDL Industries warnings and instructions, national state and local codes and all applicable ANSI standards.

NDL Industries product specifications in U.S. customary units and metric are approximate and are provided for reference only. For precise measurements, please contact Customer

Service. NDL Industries reserves the right to change or modify product design, construction, specifications, or materials without prior notice and without incurring any obligation to make such changes and modifications on NDL products previously or subsequently sold.

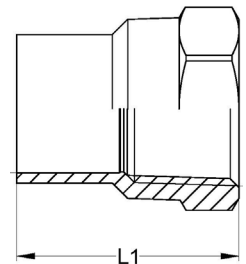

Explore our full line of high-quality HVAC-R and plumbing products.

ndlinc.com | 1-866-635-6888 | sales@ndlinc.com

@ndlindustries





Male Street Adapters

Male Street Adapter Dimensions and Selection

	PART #	OD - DESCRIPTION	BOX QTY	L1 (IN)	WT (LB)	WT (G)
	CS4-2-08	1/2" Street Adapter	EA	1.496	0.066	30.0
	CS4-2-12	3/4" Street Adapter	25	1.850	0.161	73.0
	CS4-2-16	1" Street Adapter	10	2.185	0.240	109.0
	CS4-2-32	2" Street Adapter	EA	2.894	0.800	363.0

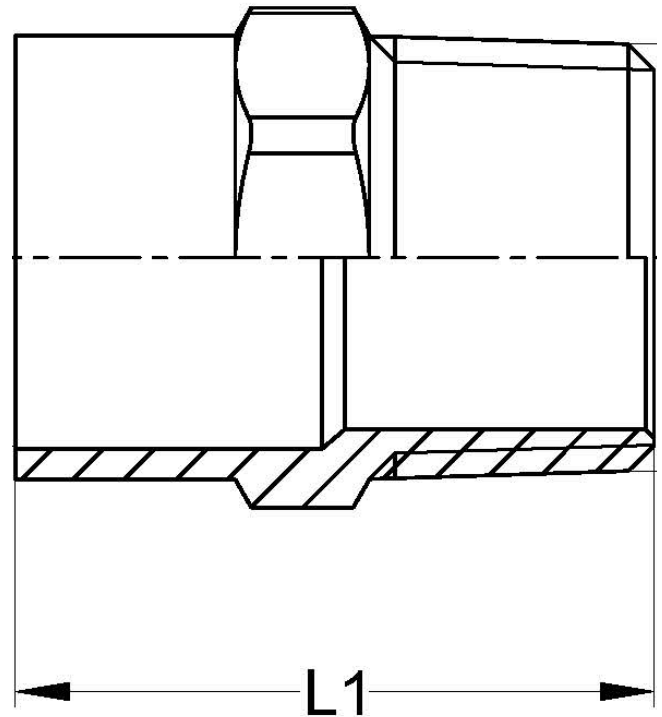

The information contained herein is not intended to replace the full product installation and safety information available or the experience of a trained product installer. You are required to thoroughly read all installation instructions and product safety information before beginning the installation of a product.

All installations must completely comply with all NDL Industries warnings and instructions, national state and local codes and all applicable ANSI standards.

NDL Industries product specifications in U.S. customary units and metric are approximate and are provided for reference only. For precise measurements, please contact Customer

Service. NDL Industries reserves the right to change or modify product design, construction, specifications, or materials without prior notice and without incurring any obligation to make such changes and modifications on NDL products previously or subsequently sold.



Explore our full line of high-quality HVAC-R and plumbing products.

ndlinc.com | 1-866-635-6888 | sales@ndlinc.com

@ndlindustries





Reducing Bushings

Reducing Bushing Dimensions and Selection

PART #	OD - DESCRIPTION	BOX QTY	L1 (IN)	WT (LB)	WT (G)
CS02-04-02	1/4" x 1/8" Reducing Bushing	100	0.827	0.008	3.5
CS02-06-02	3/8" x 1/8" Reducing Bushing	100	0.984	0.011	5.0
CS02-06-04	3/8" x 1/4" Reducing Bushing	100	0.929	0.011	5.0
CS02-08-04	1/2" x 1/4" Reducing Bushing	100	1.181	0.020	9.0
CS02-08-06	1/2" x 3/8" Reducing Bushing	100	1.126	0.020	9.0
CS02-10-04	5/8" x 1/4" Reducing Bushing	50	1.378	0.031	14.0
CS02-10-06	5/8" x 3/8" Reducing Bushing	50	1.319	0.031	14.0
CS02-10-08	5/8" x 1/2" Reducing Bushing	50	1.417	0.031	14.0
CS02-12-04	3/4" x 1/4" Reducing Bushing	50	1.496	0.044	20.0
CS02-12-06	3/4" x 3/8" Reducing Bushing	50	1.539	0.044	20.0
CS02-12-08	3/4" x 1/2" Reducing Bushing	50	1.555	0.044	20.0
CS02-12-10	3/4" x 5/8" Reducing Bushing	50	1.654	0.044	20.0
CS02-16-06	1" x 3/8" Reducing Bushing	25	1.783	0.077	35.0
CS02-16-08	1" x 1/2" Reducing Bushing	25	1.854	0.077	35.0
CS02-16-10	1" x 5/8" Reducing Bushing	25	1.870	0.088	40.0
CS02-16-12	1" x 3/4" Reducing Bushing	25	1.988	0.093	42.0
CS02-20-08	1-1/4" x 1/2" Reducing Bushing	25	2.028	0.110	50.0
CS02-20-12	1-1/4" x 3/4" Reducing Bushing	25	2.106	0.115	52.0
CS02-20-16	1-1/4" x 1" Reducing Bushing	10	2.185	0.137	62.0
CS02-24-08	1-1/2" x 1/2" Reducing Bushing	10	2.303	0.168	76.0
CS02-24-12	1-1/2" x 3/4" Reducing Bushing	10	2.402	0.168	76.0
CS02-24-16	1-1/2" x 1" Reducing Bushing	10	2.441	0.187	85.0
CS02-24-20	1-1/2" x 1-1/4" Reducing Bushing	10	2.421	0.209	95.0

The information contained herein is not intended to replace the full product installation and safety information available or the experience of a trained product installer. You are required to thoroughly read all installation instructions and product safety information before beginning the installation of a product.

All installations must completely comply with all NDL Industries warnings and instructions, national state and local codes and all applicable ANSI standards.

NDL Industries product specifications in U.S. customary units and metric are approximate and are provided for reference only. For precise measurements, please contact Customer.

Service. NDL Industries reserves the right to change or modify product design, construction, specifications, or materials without prior notice and without incurring any obligation to make such changes and modifications on NDL products previously or subsequently sold.

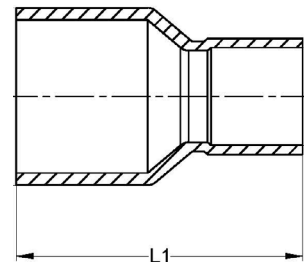

Explore our full line of high-quality HVAC-R and plumbing products.

ndlinc.com | 1-866-635-6888 | sales@ndlinc.com

@ndlindustries





Reducing Bushings - Continued

Reducing Bushing Dimensions and Selection

PART #	OD - DESCRIPTION	BOX QTY	L1 (IN)	WT (LB)	WT (G)
CS02-32-08	2" x 1/2" Reducing Bushing	10	2.795	0.309	140.0
CS02-32-12	2" x 3/4" Reducing Bushing	10	2.874	0.309	140.0
CS02-32-16	2" x 1" Reducing Bushing	10	2.913	0.313	142.0
CS02-32-20	2" x 1-1/4" Reducing Bushing	10	2.854	0.315	143.0
CS02-32-24	2" x 1-1/2" Reducing Bushing	10	2.953	0.331	150.0
CS02-40-16	2-1/2" x 1" Reducing Bushing	EA	3.366	0.595	270.0
CS02-40-20	2-1/2" x 1-1/4" Reducing Bushing	EA	3.287	0.595	270.0
CS02-40-24	2-1/2" x 1-1/2" Reducing Bushing	EA	3.287	0.595	270.0
CS02-40-32	2-1/2" x 2" Reducing Bushing	EA	3.366	0.595	270.0
CS02-48-20	3" x 1-1/4" Reducing Bushing	EA	3.760	0.882	400.0
CS02-48-24	3" x 1-1/2" Reducing Bushing	EA	3.780	0.882	400.0
CS02-48-32	3" x 2" Reducing Bushing	EA	3.740	0.882	400.0
CS02-48-40	3" x 2-1/2" Reducing Bushing	EA	3.780	0.882	400.0
CS02-56-48	3-1/2" x 3" Reducing Bushing	EA	4.232	1.323	600.0
CS02-64-32	4" x 2" Reducing Bushing	EA	4.843	1.984	900.0
CS02-64-40	4" x 2-1/2" Reducing Bushing	EA	4.843	1.984	900.0
CS02-64-48	4" x 3" Reducing Bushing	EA	4.744	1.984	900.0

The information contained herein is not intended to replace the full product installation and safety information available or the experience of a trained product installer. You are required to thoroughly read all installation instructions and product safety information before beginning the installation of a product.

All installations must completely comply with all NDL Industries warnings and instructions, national state and local codes and all applicable ANSI standards.

NDL Industries product specifications in U.S. customary units and metric are approximate and are provided for reference only. For precise measurements, please contact Customer.

Service. NDL Industries reserves the right to change or modify product design, construction, specifications, or materials without prior notice and without incurring any obligation to make such changes and modifications on NDL products previously or subsequently sold.

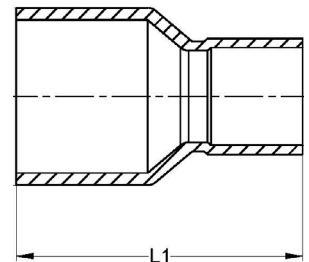

Explore our full line of high-quality HVAC-R and plumbing products.

ndlinc.com | 1-866-635-6888 | sales@ndlinc.com

@ndlindustries





Tube Caps

Tube Caps Dimensions and Selection

PART #	OD - DESCRIPTION	BOX QTY	L1 (IN)	WT (LB)	WT (G)
CS17-02	1/8" Tube Cap	EA	0.299	0.003	1.5
CS17-04	1/4" Tube Cap	100	0.394	0.005	2.3
CS17-06	3/8" Tube Cap	100	0.433	0.009	4.0
CS17-08	1/2" Tube Cap	25	0.571	0.015	7.0
CS17-10	5/8" Tube Cap	50	0.720	0.026	12.0
CS17-12	3/4" Tube Cap	25	0.870	0.033	15.0
CS17-16	1" Tube Cap	25	0.984	0.066	30.0
CS17-20	1-1/4" Tube Cap	10	1.114	0.104	47.0
CS17-24	1-1/2" Tube Cap	10	1.244	0.148	67.0
CS17-32	2" Tube Cap	10	1.528	0.265	120.0
CS17-40	2-1/2" Tube Cap	EA	1.673	0.441	200.0
CS17-48	3" Tube Cap	EA	1.890	0.540	245.0
CS17-64	4" Tube Cap	EA	2.362	1.257	570.0

The information contained herein is not intended to replace the full product installation and safety information available or the experience of a trained product installer. You are required to thoroughly read all installation instructions and product safety information before beginning the installation of a product.

All installations must completely comply with all NDL Industries warnings and instructions, national state and local codes and all applicable ANSI standards.

NDL Industries product specifications in U.S. customary units and metric are approximate and are provided for reference only. For precise measurements, please contact Customer

Service. NDL Industries reserves the right to change or modify product design, construction, specifications, or materials without prior notice and without incurring any obligation to make such changes and modifications on NDL products previously or subsequently sold.

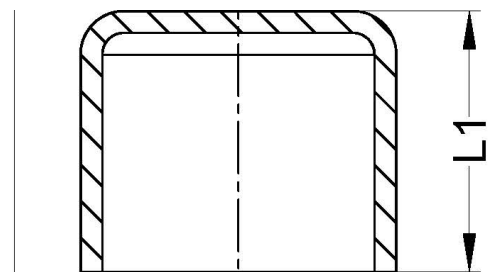



No Stop Couplings

No Stop Coupling Dimensions and Selection

	PART #	OD - DESCRIPTION	BOX QTY	L1 (IN)	WT (LB)	WT (G)
	CS0-NSTOP-04	1/4" Coupling (no stop)	100	0.665	0.008	3.4
	CS0-NSTOP-06	3/8" Coupling (no stop)	100	0.866	0.013	6.0
	CS0-NSTOP-08	1/2" Coupling (no stop)	25	1.024	0.022	10.0
	CS0-NSTOP-10	5/8" Coupling (no stop)	50	1.211	0.036	16.5
	CS0-NSTOP-12	3/4" Coupling (no stop)	25	1.535	0.051	23.0
	CS0-NSTOP-16	1" Coupling (no stop)	25	1.795	0.101	46.0
	CS0-NSTOP-20	1-1/4" Coupling (no stop)	10	1.913	0.139	63.0
	CS0-NSTOP-24	1-1/2" Coupling (no stop)	10	2.205	0.209	95.0
	CS0-NSTOP-32	2" Coupling (no stop)	5	2.717	0.379	172.0
	CS0-NSTOP-40	2-1/2" Coupling (no stop)	EA	2.972	0.595	270.0
	CS0-NSTOP-48	3" Coupling (no stop)	EA	3.366	0.904	410.0
	CS0-NSTOP-56	3-1/2" Coupling (no stop)	EA	3.811	1.323	600.0
	CS0-NSTOP-64	4" Coupling (no stop)	EA	4.323	1.905	864.0

The information contained herein is not intended to replace the full product installation and safety information available or the experience of a trained product installer. You are required to thoroughly read all installation instructions and product safety information before beginning the installation of a product.

All installations must completely comply with all NDL Industries warnings and instructions, national state and local codes and all applicable ANSI standards.

NDL Industries product specifications in U.S. customary units and metric are approximate and are provided for reference only. For precise measurements, please contact Customer

Service. NDL Industries reserves the right to change or modify product design, construction, specifications, or materials without prior notice and without incurring any obligation to make such changes and modifications on NDL products previously or subsequently sold.

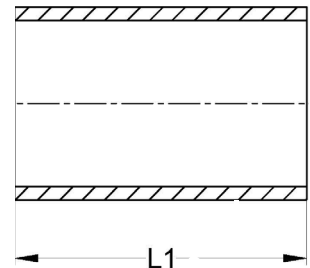

Explore our full line of high-quality HVAC-R and plumbing products.

ndlinc.com | 1-866-635-6888 | sales@ndlinc.com

@ndlindustries





Couplings with Stop

Coupling with Stop Dimensions and Selection

PART #	OD - DESCRIPTION	BOX QTY	L1 (IN)	WT (LB)	WT (G)
CS0-04	1/4" Coupling with stop	25	0.748	0.008	3.4
CS0-06	3/8" Coupling with stop	100	0.866	0.013	6.0
CS0-08	1/2" Coupling with stop	25	1.083	0.022	10.0
CS0-10	5/8" Coupling with stop	50	1.319	0.036	16.5
CS0-12	3/4" Coupling with stop	25	1.594	0.051	23.0
CS0-16	1" Coupling with stop	25	1.909	0.101	46.0
CS0-20	1-1/4" Coupling with stop	10	2.028	0.139	63.0
CS0-24	1-1/2" Coupling with stop	10	2.303	0.209	95.0
CS0-32	2" Coupling with stop	5	2.835	0.379	172.0
CS0-40	2-1/2" Coupling with stop	EA	3.169	0.617	280.0
CS0-48	3" Coupling with stop	EA	3.602	0.926	420.0
CS0-56	3-1/2" Coupling with stop	EA	4.114	1.323	600.0
CS0-64	4" Coupling with stop	EA	4.587	1.905	864.0

The information contained herein is not intended to replace the full product installation and safety information available or the experience of a trained product installer. You are required to thoroughly read all installation instructions and product safety information before beginning the installation of a product.

All installations must completely comply with all NDL Industries warnings and instructions, national state and local codes and all applicable ANSI standards.

NDL Industries product specifications in U.S. customary units and metric are approximate and are provided for reference only. For precise measurements, please contact Customer.

Service. NDL Industries reserves the right to change or modify product design, construction, specifications, or materials without prior notice and without incurring any obligation to make such changes and modifications on NDL products previously or subsequently sold.

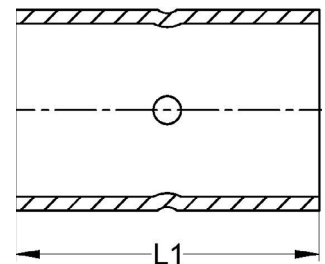



Couplings with Rolled Stop

Coupling with Rolled Stop Dimensions and Selection

PART #	OD - DESCRIPTION	BOX QTY	L1 (IN)	WT (LB)	WT (G)
CS0-RING-02	1/8" Coupling with rolled stop	100	0.602	0.004	1.6
CS0-RING-04	1/4" Coupling with rolled stop	100	0.681	0.008	3.4
CS0-RING-06	3/8" Coupling with rolled stop	100	0.843	0.012	5.5
CS0-RING-08	1/2" Coupling with rolled stop	25	1.098	0.023	10.5
CS0-RING-10	5/8" Coupling with rolled stop	50	1.319	0.036	16.5
CS0-RING-12	3/4" Coupling with rolled stop	25	1.555	0.051	23.0
CS0-RING-16	1" Coupling with rolled stop	25	1.909	0.104	47.0
CS0-RING-20	1-1/4" Coupling with rolled stop	10	2.028	0.139	63.0
CS0-RING-24	1-1/2" Coupling with rolled stop	10	2.307	0.214	97.0
CS0-RING-32	2" Coupling with rolled stop	5	2.854	0.392	178.0

The information contained herein is not intended to replace the full product installation and safety information available or the experience of a trained product installer. You are required to thoroughly read all installation instructions and product safety information before beginning the installation of a product.

All installations must completely comply with all NDL Industries warnings and instructions, national state and local codes and all applicable ANSI standards.

NDL Industries product specifications in U.S. customary units and metric are approximate and are provided for reference only. For precise measurements, please contact Customer

Service. NDL Industries reserves the right to change or modify product design, construction, specifications, or materials without prior notice and without incurring any obligation to make such changes and modifications on NDL products previously or subsequently sold.

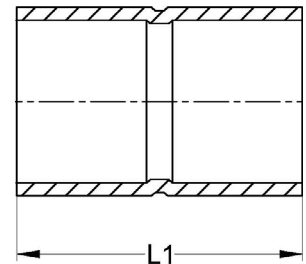

Explore our full line of high-quality HVAC-R and plumbing products.

ndlinc.com | 1-866-635-6888 | sales@ndlinc.com

@ndlindustries





Reducing Couplings

Reducing Coupling Dimensions and Selection

PART #	OD - DESCRIPTION	BOX QTY	L1 (IN)	WT (LB)	WT (G)
CS0-04-02	1/4" x 1/8" Reducing Coupling	25	0.787	0.008	3.8
CS0-06-02	3/8" x 1/8" Reducing Coupling	100	0.957	0.013	5.8
CS0-06-04	3/8" x 1/4" Reducing Coupling	100	0.898	0.012	5.6
CS0-06-05	3/8" OD x 5/16" OD Reducing Coupling	100	0.827	0.008	3.8
CS0-08-02	1/2" x 1/8" Reducing Coupling	100	1.181	0.023	10.5
CS0-08-04	1/2" x 1/4" Reducing Coupling	100	1.110	0.023	10.5
CS0-08-06	1/2" x 3/8" Reducing Coupling	100	1.114	0.022	10.0
CS0-10-04	5/8" x 1/4" Reducing Coupling	50	1.339	0.035	16.0
CS0-10-06	5/8" x 3/8" Reducing Coupling	50	1.335	0.035	16.0
CS0-10-08	5/8" x 1/2" Reducing Coupling	50	1.331	0.035	16.0
CS0-12-04	3/4" x 1/4" Reducing Coupling	50	1.496	0.049	22.0
CS0-12-06	3/4" x 3/8" Reducing Coupling	50	1.496	0.049	22.0
CS0-12-08	3/4" x 1/2" Reducing Coupling	50	1.594	0.049	22.0
CS0-12-10	3/4" x 5/8" Reducing Coupling	50	1.673	0.049	22.0
CS0-16-06	1" x 3/8" Reducing Coupling	25	1.764	0.077	35.0
CS0-16-08	1" x 1/2" Reducing Coupling	25	1.850	0.084	38.0
CS0-16-10	1" x 5/8" Reducing Coupling	25	1.882	0.084	38.0
CS0-16-12	1" x 3/4" Reducing Coupling	25	2.008	0.099	45.0
CS0-20-08	1-1/4" x 1/2" Reducing Coupling	25	2.031	0.137	62.0
CS0-20-12	1-1/4" x 3/4" Reducing Coupling	25	2.126	0.115	52.0
CS0-20-16	1-1/4" x 1" Reducing Coupling	10	2.205	0.137	62.0
CS0-24-08	1-1/2" x 1/2" Reducing Coupling	10	2.264	0.163	74.0
CS0-24-12	1-1/2" x 3/4" Reducing Coupling	10	2.358	0.179	81.0

The information contained herein is not intended to replace the full product installation and safety information available or the experience of a trained product installer. You are required to thoroughly read all installation instructions and product safety information before beginning the installation of a product.

All installations must completely comply with all NDL Industries warnings and instructions, national state and local codes and all applicable ANSI standards.

NDL Industries product specifications in U.S. customary units and metric are approximate and are provided for reference only. For precise measurements, please contact Customer

Service. NDL Industries reserves the right to change or modify product design, construction, specifications, or materials without prior notice and without incurring any obligation to make such changes and modifications on NDL products previously or subsequently sold.

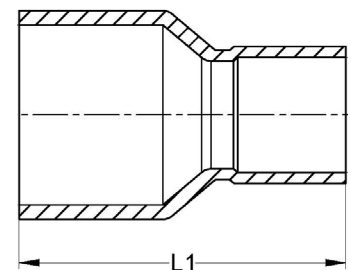

Explore our full line of high-quality HVAC-R and plumbing products.

ndlinc.com | 1-866-635-6888 | sales@ndlinc.com

@ndlindustries





Reducing Couplings - Continued

Reducing Coupling Dimensions and Selection

PART #	OD - DESCRIPTION	BOX QTY	L1 (IN)	WT (LB)	WT (G)
CS0-24-16	1-1/2" x 1" Reducing Coupling	10	2.496	0.187	85.0
CS0-24-20	1-1/2" x 1-1/4" Reducing Coupling	10	2.382	0.198	90.0
CS0-32-08	2" x 1/2" Reducing Coupling	10	2.776	0.291	132.0
CS0-32-12	2" x 3/4" Reducing Coupling	10	2.894	0.309	140.0
CS0-32-16	2" x 1" Reducing Coupling	10	3.000	0.318	144.0
CS0-32-20	2" x 1-1/4" Reducing Coupling	10	2.961	0.331	150.0
CS0-32-24	2" x 1-1/2" Reducing Coupling	10	2.933	0.335	152.0
CS0-40-16	2-1/2" x 1" Reducing Coupling	EA	3.409	0.540	245.0
CS0-40-20	2-1/2" x 1-1/4" Reducing Coupling	EA	3.142	0.540	245.0
CS0-40-24	2-1/2" x 1-1/2" Reducing Coupling	EA	3.429	0.540	245.0
CS0-40-32	2-1/2" x 2" Reducing Coupling	EA	3.425	0.628	285.0
CS0-48-24	3" x 1-1/2" Reducing Coupling	EA	3.780	0.776	352.0
CS0-48-32	3" x 2" Reducing Coupling	EA	3.819	0.827	375.0
CS0-48-40	3" x 2-1/2" Reducing Coupling	EA	3.780	0.904	410.0
CS0-56-48	3-1/2" x 3" Reducing Coupling	EA	4.264	1.323	600.0
CS0-64-32	4" x 2" Reducing Coupling	EA	4.827	1.984	900.0
CS0-64-40	4" x 2-1/2" Reducing Coupling	EA	4.862	1.984	900.0
CS0-64-48	4" x 3" Reducing Coupling	EA	4.874	1.984	900.0
CS0-64-56	4" x 3-1/2" Reducing Coupling	EA	4.567	1.984	900.0

The information contained herein is not intended to replace the full product installation and safety information available or the experience of a trained product installer. You are required to thoroughly read all installation instructions and product safety information before beginning the installation of a product.

All installations must completely comply with all NDL Industries warnings and instructions, national state and local codes and all applicable ANSI standards.

NDL Industries product specifications in U.S. customary units and metric are approximate and are provided for reference only. For precise measurements, please contact Customer.

Service. NDL Industries reserves the right to change or modify product design, construction, specifications, or materials without prior notice and without incurring any obligation to make such changes and modifications on NDL products previously or subsequently sold.

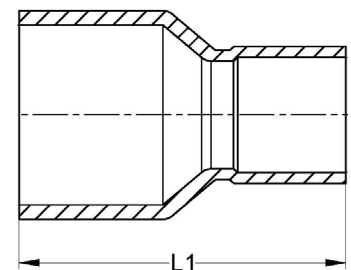

Explore our full line of high-quality HVAC-R and plumbing products.

ndlinc.com | 1-866-635-6888 | sales@ndlinc.com

@ndlindustries





Street Elbows

Street Elbow Dimensions and Selection

PART #	OD - DESCRIPTION	BOX QTY	L1 (IN)	L2 (IN)	WT (LB)	WT (G)
CS7-2-04	1/4" 90° Street Elbow	100	0.827	0.984	0.013	6.0
CS7-2-06	3/8" 90° Street Elbow	100	1.063	1.220	0.021	9.5
CS7-2-08	1/2" 90° Street Elbow	25	1.201	1.378	0.035	16.0
CS7-2-12	3/4" 90° Street Elbow	25	1.703	1.862	0.079	36.0
CS7-2-16	1" 90° Street Elbow	20	2.244	2.484	0.163	74.0
CS7-2-20	1-1/4" 90° Street Elbow	10	2.563	2.835	0.243	110.0
CS7-2-24	1-1/2" 90° Street Elbow	5	3.031	3.346	0.364	165.0
CS7-2-32	2" 90° Street Elbow	EA	3.740	4.213	0.672	305.0
CS7-2-40	2-1/2" 90° Street Elbow	EA	4.508	4.941	1.124	510.0
CS7-2-48	3" 90° Street Elbow	EA	5.238	5.368	1.764	800.0
CS7-2-64	4" 90° Street Elbow	EA	7.030	7.441	3.417	1550.0

The information contained herein is not intended to replace the full product installation and safety information available or the experience of a trained product installer. You are required to thoroughly read all installation instructions and product safety information before beginning the installation of a product.

All installations must completely comply with all NDL Industries warnings and instructions, national state and local codes and all applicable ANSI standards.

NDL Industries product specifications in U.S. customary units and metric are approximate and are provided for reference only. For precise measurements, please contact Customer

Service. NDL Industries reserves the right to change or modify product design, construction, specifications, or materials without prior notice and without incurring any obligation to make such changes and modifications on NDL products previously or subsequently sold.

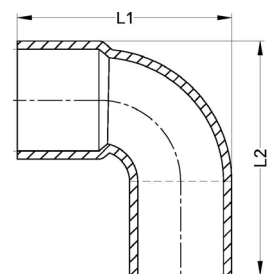

Explore our full line of high-quality
HVAC-R and plumbing products.

ndlinc.com | 1-866-635-6888 | sales@ndlinc.com

@ndlindustries





45° Elbows

45° Elbow Dimensions and Selection

PART #	OD - DESCRIPTION	BOX QTY	L1 (IN)	WT (LB)	WT (G)
CS6-02	1/8" 45° Elbow	100	0.630	0.008	3.5
CS6-04	1/4" 45° Elbow	100	0.709	0.012	5.2
CS6-06	3/8" 45° Elbow	25	0.815	0.018	8.0
CS6-08	1/2" 45° Elbow	25	1.094	0.031	14.0
CS6-10	5/8" 45° Elbow	50	1.335	0.049	22.0
CS6-12	3/4" 45° Elbow	25	1.516	0.060	27.0
CS6-16	1" 45° Elbow	20	1.831	0.099	45.0
CS6-20	1-1/4" 45° Elbow	10	2.008	0.201	91.0
CS6-24	1-1/2" 45° Elbow	5	2.307	0.304	138.0
CS6-32	2" 45° Elbow	-	2.677	0.547	248.0
CS6-40	2-1/2" 45° Elbow	EA	2.943	0.893	405.0
CS6-48	3" 45° Elbow	EA	3.329	1.433	650.0
CS6-56	3-1/2" 45° Elbow	EA	3.919	2.205	1000.0
CS6-64	4" 45° Elbow	EA	4.372	2.535	1150.0

The information contained herein is not intended to replace the full product installation and safety information available or the experience of a trained product installer. You are required to thoroughly read all installation instructions and product safety information before beginning the installation of a product.

All installations must completely comply with all NDL Industries warnings and instructions, national state and local codes and all applicable ANSI standards.

NDL Industries product specifications in U.S. customary units and metric are approximate and are provided for reference only. For precise measurements, please contact Customer

Service. NDL Industries reserves the right to change or modify product design, construction, specifications, or materials without prior notice and without incurring any obligation to make such changes and modifications on NDL products previously or subsequently sold.

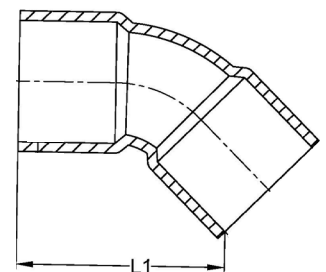

Explore our full line of high-quality HVAC-R and plumbing products.

ndlinc.com | 1-866-635-6888 | sales@ndlinc.com

@ndlindustries





45° Street Elbows

45° Street Elbow Dimensions and Selection

PART #	OD - DESCRIPTION	BOX QTY	L1 (IN)	L2 (IN)	WT (LB)	WT (G)
CS6-2-04	1/4" 45° Street Elbow	100	0.791	0.795	0.012	5.5
CS6-2-06	3/8" 45° Street Elbow	100	0.945	0.953	0.019	8.5
CS6-2-08	1/2" 45° Street Elbow	25	1.201	1.209	0.031	14.0
CS6-2-10	5/8" 45° Street Elbow	50	1.457	1.453	0.052	23.5
CS6-2-12	3/4" 45° Street Elbow	25	1.673	1.661	0.075	34.0
CS6-2-16	1" 45° Street Elbow	20	2.004	2.035	0.128	58.0
CS6-2-20	1-1/4" 45° Street Elbow	10	2.146	2.106	0.198	90.0
CS6-2-24	1-1/2" 45° Street Elbow	5	2.500	2.461	0.298	135.0
CS6-2-32	2" 45° Street Elbow	EA	2.874	2.835	0.551	250.0
CS6-2-40	2-1/2" 45° Street Elbow	EA	3.209	3.189	0.904	410.0
CS6-2-48	3" 45° Street Elbow	EA	3.565	3.585	1.499	680.0

The information contained herein is not intended to replace the full product installation and safety information available or the experience of a trained product installer. You are required to thoroughly read all installation instructions and product safety information before beginning the installation of a product.

All installations must completely comply with all NDL Industries warnings and instructions, national state and local codes and all applicable ANSI standards.

NDL Industries product specifications in U.S. customary units and metric are approximate and are provided for reference only. For precise measurements, please contact Customer

Service. NDL Industries reserves the right to change or modify product design, construction, specifications, or materials without prior notice and without incurring any obligation to make such changes and modifications on NDL products previously or subsequently sold.

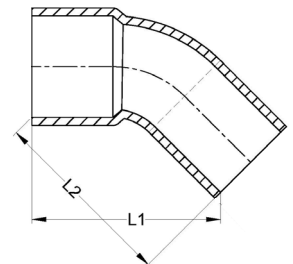

Explore our full line of high-quality HVAC-R and plumbing products.

ndlinc.com | 1-866-635-6888 | sales@ndlinc.com

@ndlindustries





90° Long Radius Elbows

90° Long Radius Elbow Dimensions and Selection

PART #	OD - DESCRIPTION	BOX QTY	L1 (IN)	WT (LB)	WT (G)
CS7LT-02	1/8" 90° Long Radius Elbow	100	0.906	0.011	5.0
CS7LT-05	5/16" 90° Long Radius Elbow	100	1.142	0.017	7.8
CS7LT-04	1/4" 90° Long Radius Elbow	25	1.260	0.020	9.0
CS7LT-06	3/8" 90° Long Radius Elbow	100	1.295	0.030	13.5
CS7LT-08	1/2" 90° Long Radius Elbow	25	1.654	0.050	22.5
CS7LT-10	5/8" 90° Long Radius Elbow	50	2.008	0.077	35.0
CS7LT-12	3/4" 90° Long Radius Elbow	25	2.264	0.115	52.0
CS7LT-16	1" 90° Long Radius Elbow	10	2.992	0.216	98.0
CS7LT-20	1-1/4" 90° Long Radius Elbow	10	3.547	0.364	165.0
CS7LT-24	1-1/2" 90° Long Radius Elbow	5	4.094	0.540	245.0
CS7LT-32	2" 90° Long Radius Elbow	EA	5.276	0.992	450.0
CS7LT-40	2-1/2" 90° Long Radius Elbow	EA	6.083	1.499	680.0
CS7LT-48	3" 90° Long Radius Elbow	EA	7.325	2.535	1150.0
CS7LT-64	4" 90° Long Radius Elbow	EA	9.065	5.126	2325.0

The information contained herein is not intended to replace the full product installation and safety information available or the experience of a trained product installer. You are required to thoroughly read all installation instructions and product safety information before beginning the installation of a product.

All installations must completely comply with all NDL Industries warnings and instructions, national state and local codes and all applicable ANSI standards.

NDL Industries product specifications in U.S. customary units and metric are approximate and are provided for reference only. For precise measurements, please contact Customer

Service. NDL Industries reserves the right to change or modify product design, construction, specifications, or materials without prior notice and without incurring any obligation to make such changes and modifications on NDL products previously or subsequently sold.

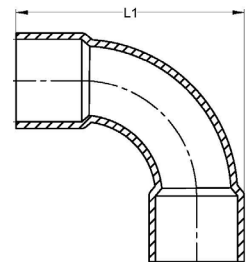

Explore our full line of high-quality HVAC-R and plumbing products.

ndlinc.com | 1-866-635-6888 | sales@ndlinc.com

@ndlindustries





90° Short Radius Elbows

90° Short Radius Elbow Dimensions and Selection

	PART #	OD - DESCRIPTION	BOX QTY	L1 (IN)	WT (LB)	WT (G)
	CS7-02	1/8" 90° Short Radius Elbow	100	0.748	0.008	3.5
	CS7-04	1/4" 90° Short Radius Elbow	100	0.866	0.013	6.0
	CS7-06	3/8" 90° Short Radius Elbow	100	1.043	0.020	9.0
	CS7-08	1/2" 90° Short Radius Elbow	25	1.280	0.034	15.2
	CS7-12	3/4" 90° Short Radius Elbow	25	1.772	0.065	29.5
	CS7-16	1" 90° Short Radius Elbow	20	2.205	0.121	55.0
	CS7-20	1-1/4" 90° Short Radius Elbow	10	2.551	0.225	102.0
	CS7-24	1-1/2" 90° Short Radius Elbow	5	2.933	0.331	150.0
	CS7-32	2" 90° Short Radius Elbow	EA	3.839	0.639	290.0
	CS7-40	2-1/2" 90° Short Radius Elbow	EA	4.575	1.102	500.0
	CS7-48	3" 90° Short Radius Elbow	EA	5.258	1.720	780.0
	CS7-64	4" 90° Short Radius Elbow	EA	7.069	3.395	1540.0

The information contained herein is not intended to replace the full product installation and safety information available or the experience of a trained product installer. You are required to thoroughly read all installation instructions and product safety information before beginning the installation of a product.

All installations must completely comply with all NDL Industries warnings and instructions, national state and local codes and all applicable ANSI standards.

NDL Industries product specifications in U.S. customary units and metric are approximate and are provided for reference only. For precise measurements, please contact Customer

Service. NDL Industries reserves the right to change or modify product design, construction, specifications, or materials without prior notice and without incurring any obligation to make such changes and modifications on NDL products previously or subsequently sold.

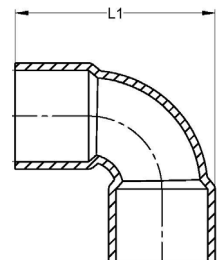

Explore our full line of high-quality HVAC-R and plumbing products.

ndlinc.com | 1-866-635-6888 | sales@ndlinc.com

@ndlindustries





Tee Dimensions and Selection

PART #	OD - DESCRIPTION	BOX QTY	L1 (IN)	L2 (IN)	WT (LB)	WT (G)
CST-02	1/8" Tee	100	0.976	0.634	0.013	6.1
CST-05	5/16" OD Tee	100	1.004	0.720	0.019	8.5
CST-04	1/4" Tee	100	1.035	0.819	0.020	9.0
CST-06	3/8" Tee	100	1.280	1.024	0.035	15.8
CST-08	1/2" Tee	25	1.646	1.209	0.058	26.5
CST-10	5/8" Tee	50	1.988	1.500	0.106	48.0
CST-12	3/4" Tee	10	2.429	1.791	0.143	65.0
CST-16	1" Tee	10	3.083	2.213	0.267	121.0
CST-20	1-1/4" Tee	10	3.445	2.559	0.375	170.0
CST-24	1-1/2" Tee	5	3.898	2.953	0.595	270.0
CST-32	2" Tee	-	4.951	3.760	1.047	475.0
CST-40	2-1/2" Tee	EA	5.817	4.439	1.720	780.0
CST-48	3" Tee	EA	6.703	5.167	2.646	1200.0
CST-64	4" Tee	EA	8.652	6.821	5.512	2500.0

The information contained herein is not intended to replace the full product installation and safety information available or the experience of a trained product installer. You are required to thoroughly read all installation instructions and product safety information before beginning the installation of a product.

All installations must completely comply with all NDL Industries warnings and instructions, national state and local codes and all applicable ANSI standards.

NDL Industries product specifications in U.S. customary units and metric are approximate and are provided for reference only. For precise measurements, please contact Customer

Service. NDL Industries reserves the right to change or modify product design, construction, specifications, or materials without prior notice and without incurring any obligation to make such changes and modifications on NDL products previously or subsequently sold.

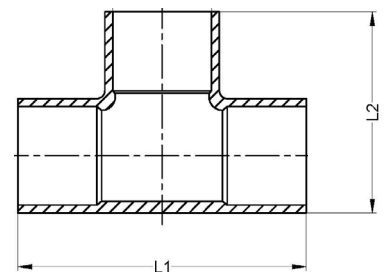

Explore our full line of high-quality
HVAC-R and plumbing products.

ndlinc.com | 1-866-635-6888 | sales@ndlinc.com

@ndlindustries





Reducing Tees

Reducing Tee Dimensions and Selection

PART #	OD - DESCRIPTION	BOX QTY	L1 (IN)	L2 (IN)	WT (LB)	WT (G)
CST-04-04-02	1/4" x 1/4" x 1/8" Reducing Tee	100	1.154	0.760	0.022	10
CST-06-06-02	3/8" x 3/8" x 1/8" Reducing Tee	100	1.142	0.858	0.042	19
CST-06-06-04	3/8" x 3/8" x 1/4" Reducing Tee	100	1.220	0.965	0.042	19
CST-08-08-02	1/2" x 1/2" x 1/8" Reducing Tee	50	1.358	1.004	0.049	22
CST-08-08-04	1/2" x 1/2" x 1/4" Reducing Tee	50	1.496	1.102	0.049	22
CST-08-08-06	1/2" x 1/2" x 3/8" Reducing Tee	50	1.555	1.142	0.049	22
CST-10-10-04	5/8" x 5/8" x 1/4" Reducing Tee	50	1.732	1.240	0.088	40
CST-10-10-06	5/8" x 5/8" x 3/8" Reducing Tee	50	1.799	1.280	0.088	40
CST-10-10-08	5/8" x 5/8" x 1/2" Reducing Tee	50	2.071	1.461	0.088	40
CST-12-12-04	3/4" x 3/4" x 1/4" Reducing Tee	25	1.929	1.327	0.115	52
CST-12-12-06	3/4" x 3/4" x 3/8" Reducing Tee	25	2.067	1.453	0.115	52
CST-12-12-08	3/4" x 3/4" x 1/2" Reducing Tee	25	2.165	1.520	0.132	60
CST-12-12-10	3/4" x 3/4" x 5/8" Reducing Tee	25	2.323	1.594	0.132	60
CST-16-16-08	1" x 1" x 1/2" Reducing Tee	10	2.539	1.850	0.231	105
CST-16-16-06	1" x 1" x 3/8" Reducing Tee	10	2.461	1.693	0.254	115
CST-16-16-10	1" x 1" x 5/8" Reducing Tee	10	2.677	1.921	0.254	115
CST-16-16-12	1" x 1" x 3/4" Reducing Tee	10	2.827	2.098	0.265	120
CST-20-20-08	1-1/4" x 1-1/4" x 1/2" Reducing Tee	10	2.677	2.106	0.32	145
CST-20-20-12	1-1/4" x 1-1/4" x 3/4" Reducing Tee	10	2.874	2.343	0.342	155
CST-20-20-16	1-1/4" x 1-1/4" x 1" Reducing Tee	10	3.189	2.441	0.342	155
CST-24-24-08	1-1/2" x 1-1/2" x 1/2" Reducing Tee	5	2.933	2.362	0.496	225
CST-24-24-12	1-1/2" x 1-1/2" x 3/4" Reducing Tee	5	3.150	2.618	0.496	225
CST-24-24-16	1-1/2" x 1-1/2" x 1" Reducing Tee	5	3.406	2.756	0.562	255

The information contained herein is not intended to replace the full product installation and safety information available or the experience of a trained product installer. You are required to thoroughly read all installation instructions and product safety information before beginning the installation of a product.

All installations must completely comply with all NDL Industries warnings and instructions, national state and local codes and all applicable ANSI standards.

NDL Industries product specifications in U.S. customary units and metric are approximate and are provided for reference only. For precise measurements, please contact Customer

Service. NDL Industries reserves the right to change or modify product design, construction, specifications, or materials without prior notice and without incurring any obligation to make such changes and modifications on NDL products previously or subsequently sold.

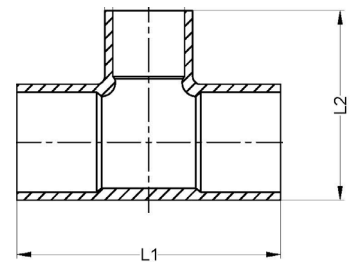



Reducing Tees - Continued

Reducing Tee Dimensions and Selection

PART #	OD - DESCRIPTION	BOX QTY	L1 (IN)	L2 (IN)	WT (LB)	WT (G)
CST-24-24-20	1-1/2" x 1-1/2" x 1-1/4" Reducing Tee	5	3.701	2.843	0.584	265
CST-32-32-08	2" x 2" x 1/2" Reducing Tee	EA	3.524	2.862	0.783	355
CST-32-32-12	2" x 2" x 3/4" Reducing Tee	-	3.730	3.098	0.827	375
CST-32-32-16	2" x 2" x 1" Reducing Tee	-	3.947	3.307	0.904	410
CST-32-32-20	2" x 2" x 1-1/4" Reducing Tee	EA	4.281	3.398	0.937	425
CST-32-32-24	2" x 2" x 1-1/2" Reducing Tee	-	4.419	3.465	1.014	460
CST-40-40-16	2-1/2" x 2-1/2" x 1" Reducing Tee	EA	4.262	3.780	1.367	620
CST-40-40-32	2-1/2" x 2-1/2" x 2" Reducing Tee	EA	5.285	4.215	1.587	720
CST-40-40-08	2-1/2" x 2-1/2" x 1/2" Reducing Tee	EA	3.927	3.622	1.653	750
CST-40-40-12	2-1/2" x 2-1/2" x 3/4" Reducing Tee	EA	4.081	3.642	1.653	750
CST-40-40-20	2-1/2" x 2-1/2" x 1-1/4" Reducing Tee	EA	4.577	3.917	1.653	750
CST-40-40-24	2-1/2" x 2-1/2" x 1-1/2" Reducing Tee	EA	4.715	4.016	1.653	750
CST-48-48-08	3" x 3" x 1/2" Reducing Tee	EA	4.705	4.567	2.976	1350
CST-48-48-12	3" x 3" x 3/4" Reducing Tee	EA	4.754	4.185	2.976	1350
CST-48-48-16	3" x 3" x 1" Reducing Tee	EA	4.715	4.370	2.976	1350
CST-48-48-20	3" x 3" x 1-1/4" Reducing Tee	EA	5.059	4.980	2.976	1350
CST-48-48-24	3" x 3" x 1-1/2" Reducing Tee	EA	5.089	4.646	2.976	1350
CST-48-48-32	3" x 3" x 2" Reducing Tee	EA	5.679	4.825	2.976	1350
CST-48-48-40	3" x 3" x 2-1/2" Reducing Tee	EA	6.112	4.963	2.976	1350
CST-64-64-48	4" x 4" x 3" Reducing Tee	EA	7.589	6.250	5.401	2450
CST-64-64-32	4" x 4" x 2" Reducing Tee	EA	6.644	6.026	5.512	2500
CST-64-64-40	4" x 4" x 2-1/2" Reducing Tee	EA	7.028	6.124	5.512	2500

The information contained herein is not intended to replace the full product installation and safety information available or the experience of a trained product installer. You are required to thoroughly read all installation instructions and product safety information before beginning the installation of a product.

All installations must completely comply with all NDL Industries warnings and instructions, national state and local codes and all applicable ANSI standards.

NDL Industries product specifications in U.S. customary units and metric are approximate and are provided for reference only. For precise measurements, please contact Customer

Service. NDL Industries reserves the right to change or modify product design, construction, specifications, or materials without prior notice and without incurring any obligation to make such changes and modifications on NDL products previously or subsequently sold.

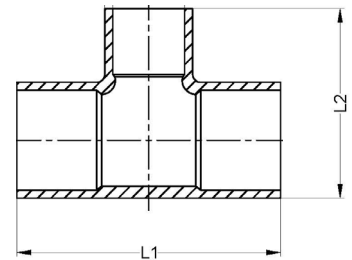

Explore our full line of high-quality HVAC-R and plumbing products.

ndlinc.com | 1-866-635-6888 | sales@ndlinc.com

@ndlindustries





Reducing Tees

Reducing Tee Dimensions and Selection

PART #	OD - DESCRIPTION	BOX QTY	L1 (IN)	L2 (IN)	WT (LB)	WT (G)
CST-04-02-02	1/4" x 1/8" x 1/8" Reducing Tee	100	1.319	0.744	0.022	10.0
CST-06-04-02	3/8" x 1/4" x 1/8" Reducing Tee	100	1.240	0.866	0.042	19.0
CST-06-04-04	3/8" x 1/4" x 1/4" Reducing Tee	100	1.366	0.921	0.042	19.0
CST-08-06-06	1/2" x 3/8" x 3/8" Reducing Tee	50	1.772	1.130	0.062	28.0
CST-10-08-08	5/8" x 1/2" x 1/2" Reducing Tee	50	2.165	1.378	0.099	45.0
CST-12-08-06	3/4" x 1/2" x 3/8" Reducing Tee	25	2.323	1.417	0.154	70.0
CST-12-08-08	3/4" x 1/2" x 1/2" Reducing Tee	25	2.421	1.508	0.137	62.0
CST-12-10-10	3/4" x 5/8" x 5/8" Reducing Tee	25	2.461	1.626	0.154	70.0
CST-16-08-08	1" x 1/2" x 1/2" Reducing Tee	10	2.717	1.841	0.254	115.0
CST-16-08-12	1" x 1/2" x 3/4" Reducing Tee	10	2.894	2.087	0.254	115.0
CST-16-12-08	1" x 3/4" x 1/2" Reducing Tee	10	2.886	1.795	0.254	115.0
CST-16-12-12	1" x 3/4" x 3/4" Reducing Tee	10	3.110	2.146	0.265	120.0
CST-20-12-12	1-1/4" x 3/4" x 3/4" Reducing Tee	10	3.417	2.307	0.375	170.0
CST-20-12-16	1-1/4" x 3/4" x 1" Reducing Tee	10	3.543	2.500	0.375	170.0
CST-20-16-08	1-1/4" x 1" x 1/2" Reducing Tee	10	3.071	2.094	0.375	170.0
CST-20-16-12	1-1/4" x 1" x 3/4" Reducing Tee	10	3.465	2.343	0.375	170.0
CST-20-16-16	1-1/4" x 1" x 1" Reducing Tee	10	3.724	2.441	0.397	180.0
CST-24-12-08	1-1/2" x 3/4" x 1/2" Reducing Tee	EA	3.484	2.323	0.412	186.9
CST-24-12-12	1-1/2" x 3/4" x 3/4" Reducing Tee	5	3.614	2.579	0.573	260.0
CST-24-12-16	1-1/2" x 3/4" x 1" Reducing Tee	5	3.780	2.732	0.573	260.0
CST-24-12-20	1-1/2" x 3/4" x 1-1/4" Reducing Tee	5	4.039	2.874	0.573	260.0
CST-24-16-08	1-1/2" x 1" x 1/2" Reducing Tee	EA	4.193	2.921	0.392	177.8
CST-24-16-12	1-1/2" x 1" x 3/4" Reducing Tee	5	3.701	2.638	0.573	260.0

The information contained herein is not intended to replace the full product installation and safety information available or the experience of a trained product installer. You are required to thoroughly read all installation instructions and product safety information before beginning the installation of a product.

All installations must completely comply with all NDL Industries warnings and instructions, national state and local codes and all applicable ANSI standards.

NDL Industries product specifications in U.S. customary units and metric are approximate and are provided for reference only. For precise measurements, please contact Customer

Service. NDL Industries reserves the right to change or modify product design, construction, specifications, or materials without prior notice and without incurring any obligation to make such changes and modifications on NDL products previously or subsequently sold.

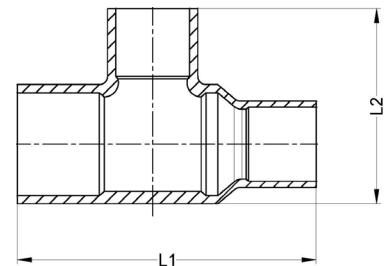



Reducing Tees - Continued

Reducing Tee Dimensions and Selection

PART #	OD - DESCRIPTION	BOX QTY	L1 (IN)	L2 (IN)	WT (LB)	WT (G)
CST-24-16-16	1-1/2" x 1" x 1" Reducing Tee	5	3.917	2.732	0.573	260.0
CST-24-20-12	1-1/2" x 1-1/4" x 3/4" Reducing Tee	5	3.563	2.579	0.573	260.0
CST-24-20-16	1-1/2" x 1-1/4" x 1" Reducing Tee	5	3.917	2.732	0.573	260.0
CST-24-20-20	1-1/2" x 1-1/4" x 1-1/4" Reducing Tee	5	4.114	2.884	0.573	260.0
CST-32-20-16	2" x 1-1/4" x 1" Reducing Tee	EA	4.443	3.252	0.926	420.0
CST-32-20-20	2" x 1-1/4" x 1-1/4" Reducing Tee	EA	4.648	3.386	0.926	420.0
CST-32-20-24	2" x 1-1/4" x 1-1/2" Reducing Tee	EA	5.002	3.614	0.926	420.0
CST-32-24-12	2" x 1-1/2" x 3/4" Reducing Tee	EA	4.274	3.071	0.757	343.4
CST-32-24-16	2" x 1-1/2" x 1" Reducing Tee	EA	4.530	3.307	0.926	420.0
CST-32-24-20	2" x 1-1/2" x 1-1/4" Reducing Tee	EA	4.549	3.406	0.926	420.0
CST-32-24-24	2" x 1-1/2" x 1-1/2" Reducing Tee	EA	5.002	3.622	0.926	420.0
CST-40-32-16	2-1/2" x 2" x 1" Reducing Tee	EA	4.821	3.799	1.653	750.0
CST-40-32-20	2-1/2" x 2" x 1-1/4" Reducing Tee	EA	5.337	3.898	1.653	750.0
CST-40-32-24	2-1/2" x 2" x 1-1/2" Reducing Tee	EA	5.433	4.016	1.653	750.0
CST-40-32-32	2-1/2" x 2" x 2" Reducing Tee	EA	5.829	4.254	1.653	750.0
CST-48-32-32	3" x 2" x 2" Reducing Tee	EA	6.360	4.825	2.976	1350.0
CST-48-40-32	3" x 2-1/2" x 2" Reducing Tee	EA	6.163	4.884	2.976	1350.0
CST-48-40-40	3" x 2-1/2" x 2-1/2" Reducing Tee	EA	6.793	4.856	2.976	1350.0

The information contained herein is not intended to replace the full product installation and safety information available or the experience of a trained product installer. You are required to thoroughly read all installation instructions and product safety information before beginning the installation of a product.

All installations must completely comply with all NDL Industries warnings and instructions, national state and local codes and all applicable ANSI standards.

NDL Industries product specifications in U.S. customary units and metric are approximate and are provided for reference only. For precise measurements, please contact Customer

Service. NDL Industries reserves the right to change or modify product design, construction, specifications, or materials without prior notice and without incurring any obligation to make such changes and modifications on NDL products previously or subsequently sold.

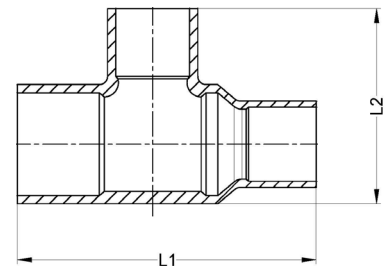

Explore our full line of high-quality HVAC-R and plumbing products.

ndlinc.com | 1-866-635-6888 | sales@ndlinc.com

@ndlindustries





Reducing Tees

Reducing Tee Dimensions and Selection

	PART #	OD - DESCRIPTION	BOX QTY	L1 (IN)	L2 (IN)	WT (LB)	WT (G)
	CST-02-02-04	1/8" x 1/8" x 1/4" Reducing Tee	100	1.102	0.728	0.028	12.5
	CST-04-04-06	1/4" x 1/4" x 3/8" Reducing Tee	100	1.220	0.965	0.044	20
	CST-08-08-12	1/2" x 1/2" x 3/4" Reducing Tee	25	1.909	1.677	0.106	48
	CST-12-12-16	3/4" x 3/4" x 1" Reducing Tee	10	2.736	2.047	0.221	100
	CST-08-08-16	1/2" x 1/2" x 1" Reducing Tee	10	2.362	1.929	0.243	110
	CST-16-16-20	1" x 1" x 1-1/4" Reducing Tee	10	3.307	2.461	0.397	180
	CST-20-20-24	1-1/4" x 1-1/4" x 1-1/2" Reducing Tee	5	3.673	2.972	0.523	237.2
	CST-16-16-24	1" x 1" x 1-1/2" Reducing Tee	5	3.583	2.559	0.551	250
	CST-20-20-32	1-1/4" x 1-1/4" x 2" Reducing Tee	EA	5.925	3.809	1.102	500
	CST-24-24-32	1-1/2" x 1-1/2" x 2" Reducing Tee	EA	5.650	3.821	1.323	600

The information contained herein is not intended to replace the full product installation and safety information available or the experience of a trained product installer. You are required to thoroughly read all installation instructions and product safety information before beginning the installation of a product.

All installations must completely comply with all NDL Industries warnings and instructions, national state and local codes and all applicable ANSI standards.

NDL Industries product specifications in U.S. customary units and metric are approximate and are provided for reference only. For precise measurements, please contact Customer

Service. NDL Industries reserves the right to change or modify product design, construction, specifications, or materials without prior notice and without incurring any obligation to make such changes and modifications on NDL products previously or subsequently sold.

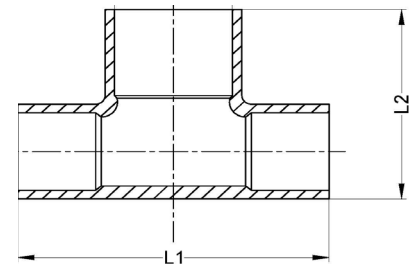



Reducing Tees

Reducing Tee Dimensions and Selection

PART #	OD - DESCRIPTION	BOX QTY	L1 (IN)	L2 (IN)	WT (LB)	WT (G)
CST-04-02-04	1/4" x 1/8" x 1/4" Reducing Tee	100	1.280	0.787	0.022	10.0
CST-06-02-06	3/8" x 1/8" x 3/8" Reducing Tee	100	1.516	0.984	0.042	19.0
CST-06-04-06	3/8" x 1/4" x 3/8" Reducing Tee	100	1.480	1.024	0.038	17.0
CST-08-06-08	1/2" x 3/8" x 1/2" Reducing Tee	50	1.882	1.260	0.062	28.0
CST-12-08-12	3/4" x 1/2" x 3/4" Reducing Tee	25	2.638	1.756	0.159	72.0
CST-16-08-16	1" x 1/2" x 1" Reducing Tee	10	3.280	2.201	0.287	130.0
CST-16-12-16	1" x 3/4" x 1" Reducing Tee	10	3.346	2.197	0.298	135.0
CST-20-12-20	1-1/4" x 3/4" x 1-1/4" Reducing Tee	10	3.839	2.567	0.419	190.0
CST-20-16-20	1-1/4" x 1" x 1-1/4" Reducing Tee	10	3.819	2.559	0.430	195.0
CST-24-08-24	1-1/2" x 1/2" x 1-1/2" Reducing Tee	EA	4.390	2.898	0.565	256.3
CST-24-12-24	1-1/2" x 3/4" x 1-1/2" Reducing Tee	5	4.370	2.953	0.661	300.0
CST-24-16-24	1-1/2" x 1" x 1-1/2" Reducing Tee	5	4.370	2.898	0.661	300.0
CST-24-20-24	1-1/2" x 1-1/4" x 1-1/2" Reducing Tee	5	4.193	2.898	0.661	300.0
CST-32-12-32	2" x 3/4" x 2" Reducing Tee	EA	5.553	3.762	1.094	496.2
CST-32-20-32	2" x 1-1/4" x 2" Reducing Tee	EA	5.652	3.762	1.102	500.0
CST-32-24-32	2" x 1-1/2" x 2" Reducing Tee	EA	5.478	3.762	1.102	500.0
CST-40-24-40	2" x 1-1/2" x 2-1/2" Reducing Tee	EA	6.439	4.470	1.874	850.0
CST-40-32-40	2-1/2" x 2" x 2-1/2" Reducing Tee	EA	6.459	4.490	1.874	850.0
CST-48-32-48	3" x 2" x 3" Reducing Tee	EA	7.382	5.049	2.976	1350.0
CST-48-40-48	3" x 2-1/2" x 3" Reducing Tee	EA	7.285	5.238	2.976	1350.0

The information contained herein is not intended to replace the full product installation and safety information available or the experience of a trained product installer. You are required to thoroughly read all installation instructions and product safety information before beginning the installation of a product.

All installations must completely comply with all NDL Industries warnings and instructions, national state and local codes and all applicable ANSI standards.

NDL Industries product specifications in U.S. customary units and metric are approximate and are provided for reference only. For precise measurements, please contact Customer

Service. NDL Industries reserves the right to change or modify product design, construction, specifications, or materials without prior notice and without incurring any obligation to make such changes and modifications on NDL products previously or subsequently sold.

