



NDL Industries

APPLICATIONS

Commercial, Industrial, and Residential CO₂ Refrigeration

Stainless Steel Check Valves (CO₂-CVS)

NDL CO₂ check valves perform unlike any other in its class for leak prevention, reliability, and superior field performance.



CO₂-CVS Specifications

Exceptional Safety Margins

Our valves can hold five times their maximum working pressure, netting a tremendous safety margin for any ball valve used in CO₂ systems.

Quality Tested

Each valve is helium tested at the factory to guarantee leak-free performance.

Bottom-Up Stem Installation

Our stem placement is engineered from the bottom up. If there is an accidental over-pressurization in the valve, it will not blow the stem out and lose the charge.

Stainless Steel Body

The NDL CO₂ valves feature a stainless steel body for stainless steel connections.

Size and Connections

A wide range of sizes and connection types makes our valves compatible with main pipe types manufactured from copper iron alloys and stainless steel.

Unparalleled Two-year Warranty

Our warranty proves confidence, along with stamping every valve with a serial number and cleanly packaging in a poly-bag to prevent contamination and malfunctions.



Stainless Steel Check Valves

Operating Specifications

- Temperature: -40° to 302°F (-40°C to 150°C)
- Burst Pressure: 5 times the working pressure

Certifications and Approvals

- CE
- RoHS

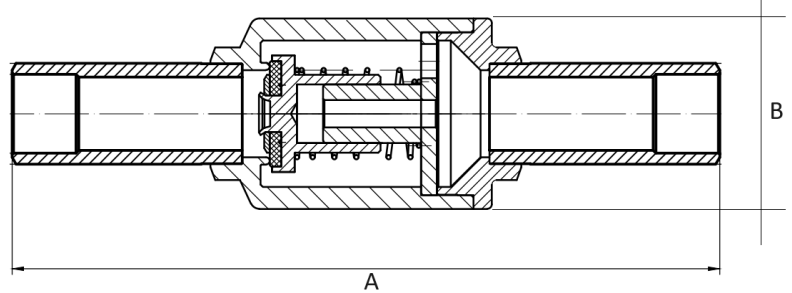

Sizes, Kv/Cv, and Pressure Ratings

PART #	CONNECTIONS W	KV	CV	MAX. OPERATING PRESSURE	
	MM	M3/H	GPM	BAR	PSI
CO2-CVS10M	10	2	2.3	140	2030
CO2-CVS12M	12	2	2.3	140	2030
CO2-CVS16M	16	3.6	4.2	140	2030
CO20CVS18M	18	3.6	4.2	140	2030
CO2-CVS22M	22	8.5	9.8	140	2030
CO2-CVS28M	28	19	22.0	140	2030
CO2-CVS35M	32	29	33.5	140	2030
CO2-CVS42M	42	-	0.0	140	2030